

ALTERNATOR DIODE FOR AUTOMOTIVE APPLICATION.

#### FEATURES

- Average Forward Current :  $I_{F(AV)}=25A$ .
- Repetitive Peak Reverse Voltage :  $V_{RRM}=200V$ .

#### POLARITY

- E25A2CS (+ Type)
- E25A2CR (- Type)

#### MAXIMUM RATING ( $T_a=25^\circ C$ )

CHARACTERISTIC	SYMBOL	RATING	UNIT
Repetitive Peak Reverse Voltage	$V_{RRM}$	200	V
Average Forward Current	$I_{F(AV)}$	25	A
Peak 1 Cycle Surge Current	$I_{FSM}$	250 (60Hz)	A
Junction Temperature	$T_j$	-40 ~ 150	$^\circ C$
Storage Temperature Range	$T_{stg}$	-40 ~ 150	$^\circ C$

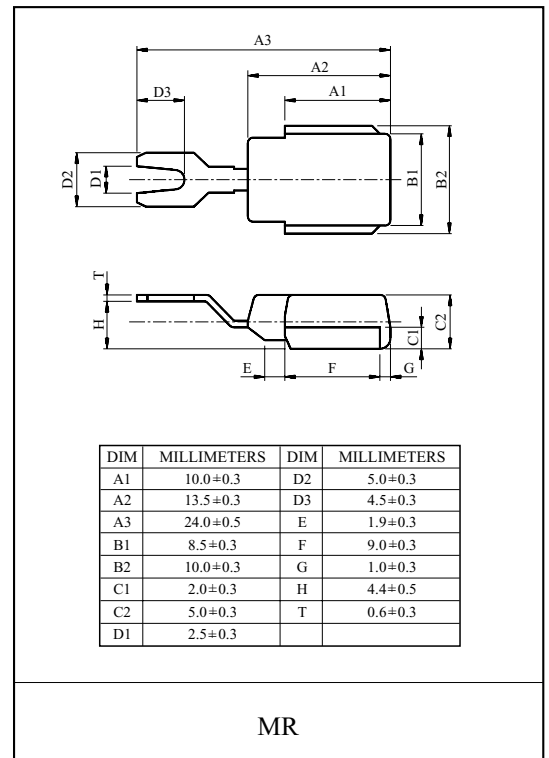

#### ELECTRICAL CHARACTERISTICS ( $T_a=25^\circ C$ )

CHARACTERISTIC	SYMBOL	TEST CONDITION	MIN.	TYP.	MAX.	UNIT
Peak Forward Voltage	$V_{FM}$	$I_{FM}=100A$	-	-	1.30	V
Reverse Voltage	$V_R$	$I_R=5mA$	200	-	-	V
Repetitive Peak Reverse Current	$I_{RRM}$	$V_{RRM}=200V$	-	-	50	$\mu A$
Reverse Recovery Time	$t_{rr}$	$I_F=0.1A, I_R=0.1A$	-	-	15	$\mu S$
Thermal Resistance	$R_{th(j-c)}$	DC total junction to case	-	-	1.0	$^\circ C/W$

# E25A2CS, E25A2CR

